



LAVO FLOORS

Laminate Flooring Owner's Manual

Installation, Maintenance & Warranty

SECTION 1

GENERAL CONDITIONS & RESPONSIBILITY

Product Inspection & Acceptance

The installer and/or owner are solely responsible for conducting a final inspection of the product prior to installation. All planks must be carefully inspected for color variation, finish consistency, and any visible defects before installation.

Installation of any plank constitutes full acceptance of its condition. **LAVO FLOORS** shall **not** be held liable for, and will not accept, any claims related to planks that have been installed despite visible defects.

1.1 Acclimatization (Crucial Step)

Laminate flooring is hygroscopic (absorbs moisture). It must adjust to the climate of the installation site.

- **Time:** Store unopened boxes flat in the room for a minimum of 48 to 72 hours before installation.
- **Spacing:** Cross-stack boxes to allow air circulation. Do not stack directly against exterior walls.
- **Environment:** Room temperature must be 18°C - 24°C (65°F - 75°F) with a Relative Humidity (RH) of 35% - 65%.

1.2 Tools Required

- Laminate flooring tapping block
- Pull bar / Pry bar
- Rubber mallet (non-marking)
- Spacers (3/8" / 10mm)
- Tape measure & Pencil
- Table saw or Circular saw (carbide-tipped blade)
- Jig saw (for cutting around pipes)
- Safety glasses & Dust mask
- Moisture meter (recommended)
- Recommended Option: Use a 6-mil polyethylene moisture barrier when installing over concrete subfloors.

SECTION 2

SUBFLOOR PREPARATION

The longevity of your floor depends on the subfloor. It must be **CLEAN, DRY, FLAT, and STRUCTURALLY SOUND.**

2.1 Flatness Requirements

- The subfloor must be flat to within **3/16" (5mm) over a 10-foot (3m) radius** or **1/8" (3mm) over a 6-foot (2m) radius.**
- Sand down high spots and fill low spots with a Portland cement-based leveling compound.
- **Warning:** Failure to level the floor may result in locking system failure or squeaking sounds.

2.2 Moisture Requirements

- **Concrete Subfloors:** Must be fully cured (min. 60 days). Moisture vapor emission must not exceed 5 lbs/1000 sq.ft/24 hours. **A 6-mil polyethylene moisture barrier is mandatory.**
- **Wood Subfloors:** Moisture content of the wood subfloor must not exceed 12%. The difference in moisture content between the subfloor and the laminate must not exceed 4%.

2.3 Radiant Heat

LAVO FLOORS laminate is approved for **Hydronic (water-based) embedded systems ONLY.** Electric mats are not recommended.

- System must be operational for at least 7 days prior to installation.
- Turn heat **OFF** 24 hours before and during installation.
- After installation, increase temperature gradually (max 2°C per day).
- Surface temperature must never exceed **27°C (80°F).**

SECTION 3

INSTALLATION INSTRUCTIONS (Visual Guide)

Note to Installer: LAVO FLOORS Laminate is a floating floor system. Do not nail, glue, or screw the planks to the subfloor.

Step 1: Preparation & Underlayment

Remove all existing carpet, padding, and tack strips. Thoroughly sweep and vacuum the subfloor. If your laminate does not have an attached pad, install a quality laminate underlayment. Tape all seams.

Do **not** install an additional underlayment if the flooring product you purchased already includes a pre-attached underlayment.

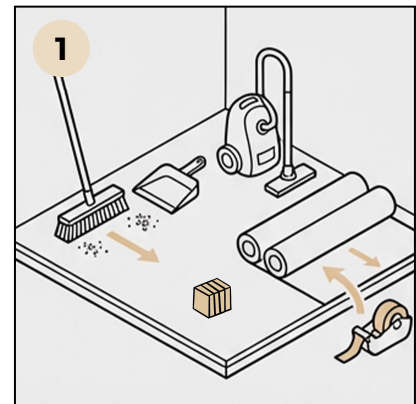

Step 2: Establishing the Expansion Gap

Insert 3/8" (10mm) spacers between the wall and the flooring. This gap must be maintained around the entire perimeter, including door frames, pipes, and cabinetry.

- Why? Laminate expands and contracts with seasons. Without this gap, the floor will buckle.

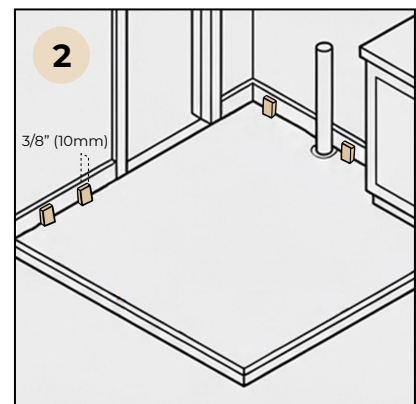

Step 3: First Row Installation

Start in the left corner of the room with the tongue side facing the wall. Cut the tongue off the long side of the planks for the first row to ensure a flush fit against the spacers.

Connect the short ends of the planks by inserting the tongue into the groove at an angle and lowering it flat.

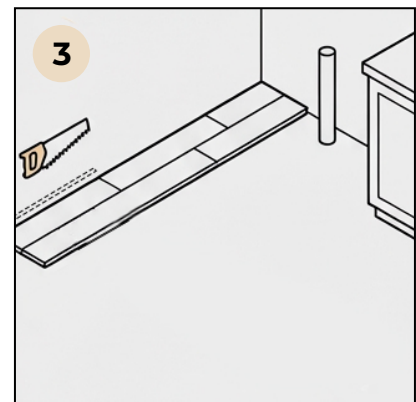

Step 4: The Cut (Staggering)

Start the second row with the cut-off piece from the previous row. End joints must be staggered by at least **12 inches (30 cm)**. This creates structural stability and a natural look.

- Visual: Ensure the pattern resembles a brick wall, not a grid.

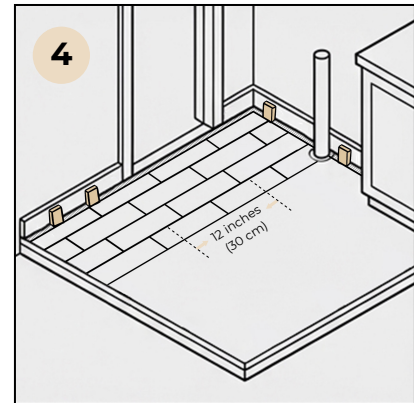

Step 5: Locking the Planks

Insert the long tongue of the new plank into the groove of the previous row at an angle of approx. 20°-30°. Press forward and fold down. You should feel it lock.

- **Use the Tapping Block:** If there is a minor gap, lightly tap the long edge with the tapping block and rubber mallet to engage the lock fully. **Never hit the plank directly.**

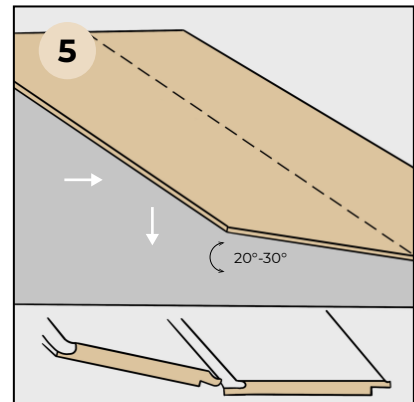

Step 6: The Last Row

Measure the remaining space (minus the 3/8" expansion gap) and cut the planks lengthwise (rip cut). Install using the **Pull Bar** to tighten the joint, as a tapping block will not fit against the wall.

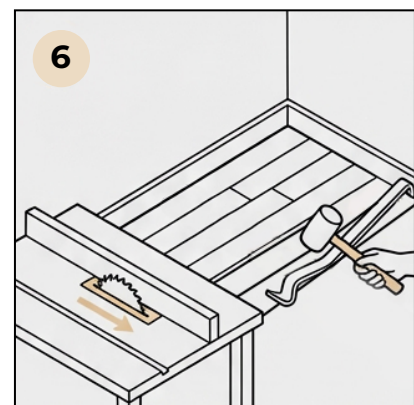

Step 7: Door Jambs & Obstacles

- **Door Jambs:** Undercut the wooden door casing with a handsaw so the laminate can slide underneath. Never try to cut the laminate to the shape of the door jamb.
- **Pipes:** Drill a hole with a diameter $3/4$ " larger than the pipe. Cut the plank through the center of the hole, install, and glue the two pieces back together behind the pipe.

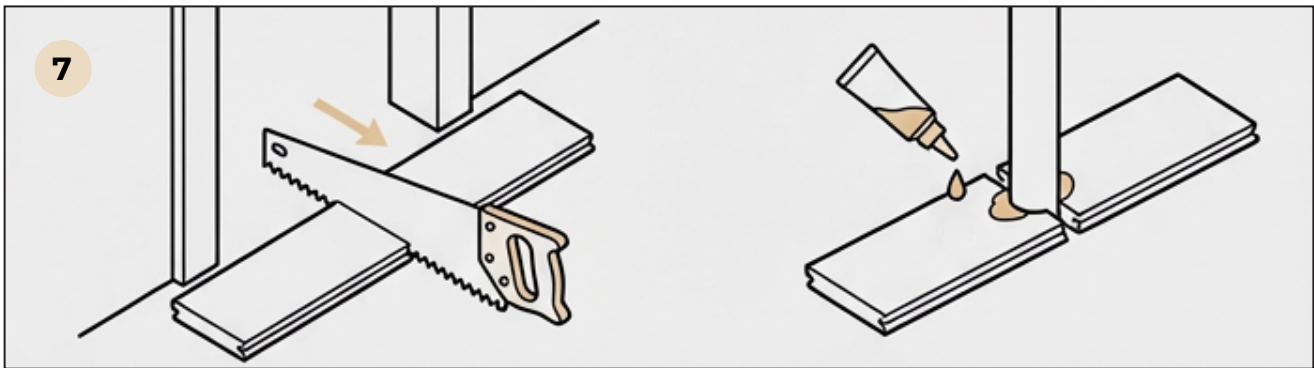

SECTION 4

MAINTENANCE & CARE

Preventative Care

- **Furniture Protection:** Use felt pads under all furniture legs and castors. Replace plastic glides with felt.
- **Entrance Mats:** Use non-rubber backed mats at all entrances to trap sand, grit, and moisture.
- **UV Protection:** Use curtains or blinds to minimize direct sunlight exposure, which can cause fading over time.

Water Resistant Laminate

The product is designed to handle everyday household moisture and routine spills without issue when properly maintained. Long-term water exposure, including multi-day soaking, standing water, or flooding, may cause damage to the flooring system and is not covered under warranty.



SECTION 5

WARRANTY DISCLAIMER

Residential Warranty: 30 Years

Light Commercial Warranty: 15 Years

Coverage:

LAVO FLOORS warrants that under normal use, the product will not:

- 1. Fade:** Visible fading due to sunlight or artificial light.
- 2. Stain:** Resists common household stains.
- 3. Wear:** The decorative layer will not wear through to the core material.

Exclusions:

This warranty does **NOT** cover:

- Damage due to improper installation (lack of expansion gaps, uneven subfloor).
- Water damage from flooding, leaking appliances, or pet urine.
- Mechanical damage (scratches, dents from heavy impacts, cutting).
- Installation in unapproved environments (outdoors, saunas, full bathrooms with floor drains).
- Visual differences between samples and installed flooring.